



# kirschfoundation

2000-2001 Annual Report



Effecting Change Through  
Strategic Giving and Advocacy



**Steven T. Kirsch**  
Co-founder & Board Chairman

**Michèle Kirsch**  
Co-founder

### **Our Vision:**

We want a safe and peaceful world, one without the threat of destruction. We want a healthy world, one without disease and without pollution of our air, water and land, and one in which all species have the ability to survive and flourish.

### **Our Mission:**

We invest in causes where high-impact, leverageable activities can result in a safer and healthier world. Using whatever means are most effective, we work to solve significant problems and issues that place individuals, the world community, and the world itself at risk.

<b>Mission/Vision</b> .....	<b>2</b>
<b>Letter from the Founders and President &amp; CEO</b> .....	<b>4</b>
<b>Foundation Activities</b>	
<b>Lobbying and Advocacy</b> .....	<b>5</b>
- Environment .....	<b>5</b>
- Nuclear Disarmament .....	<b>5</b>
- Medical/Science .....	<b>6</b>
- Campaign Finance Reform .....	<b>6</b>
<b>Grants</b> .....	<b>7</b>
- Overview .....	<b>7</b>
- Summary .....	<b>7</b>
- Major Grants .....	<b>7</b>
<b>Grants Awarded</b> .....	<b>9</b>
<b>Financial Statements</b> .....	<b>11</b>

[www.kirschfoundation.org](http://www.kirschfoundation.org)

## Dear Friends:

Our second year was a challenging one. We started the year with great plans to build on our first-year successes in lobbying and funding just as the U.S. stock market began a long, significant downturn. Despite that harsh economic reality, the Kirsch Foundation:

- Developed a reputation as a consistent and socially progressive voice in national and California public policy discussions and debates.
- Created a new medical science research funding model.
- Strengthened our knowledge of and commitment to nuclear disarmament and political reform issues and organizations.
- Maintained a strong grants program in Silicon Valley.

## Strategy and Progress

In December 2000, the Board approved a strategic plan to guide our efforts over the coming years. The goals, which tower in scope, address our concerns for the planet, the environment and all species, especially humankind:

- Ensure world safety
- Restore the world's environment to an unpolluted state
- Eliminate all diseases
- Make our community a model of a safe, healthy, and enriching environment for all residents

While some may consider us audacious, even naïve, for the extraordinary breadth of these goals, we would rather aim high than settle for less.

## Economic Overview

At the beginning of July 2000, our endowment was \$75 million. A year later, after grants, grant payments and operating expenses of \$10 million, the endowment had shrunk to \$35 million. Because there are diseases we want to cure, air quality that we want to improve, peace that we want to secure, and a community we want to help, we decided not to reduce our budget during the year, even as the asset base declined.

Our investment policy is an aggressive one, based on our belief in the long-term importance and vitality of the technology sector. Our budgeting – for operations and grants – is equally aggressive. As necessary, we will continue a high expense-to-asset percentage rate during the coming years. We would rather do what we can today in order to speed progress toward solutions than build a certain financial future for the Foundation itself.

## Our Thanks

We want to acknowledge four groups of people whose contributions greatly strengthen the Foundation. We are grateful for all they do.

- Perry Olson and Harry Saal, the independent Directors on the Board, support the Foundation's vision and insure clarity and congruence as we proceed.
- Our Scientific Advisory Board members lend their expertise to assess and select promising medical researchers.
- The Community Foundation Silicon Valley Board and staff, especially its CEO, Peter deCourcy Hero, encourage philanthropy among a new type of donor, including our Foundation.
- The talented and dedicated staff at the Foundation lives and breathes the vision and mission on a daily basis and brings us closer to our goals.

Finally, in light of the political and economic turmoil of this past year, we believe all efforts to help make the world safer and healthier are critical. We hope you join us in this work.

**Steven T. Kirsch**  
Co-founder and Board Chairman

**Michèle Kirsch**  
Co-founder

**Kathleen Gwynn**  
President/CEO/CFO

## Foundation Activities

The Foundation is substantially engaged in lobbying and educational activities, as well as grantmaking, to meet the strategic plan's goals. Our tactical flexibility enables us to put resources where they can be best deployed. And each activity leverages the resources we have devoted to the other.

Our public policy and lobbying activities enhance our effectiveness as a grantmaker. We learn about and can then support organizations that share our point of view and have demonstrated

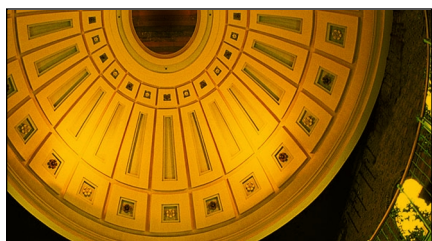

the ability to successfully advance an issue. When we became committed to cleaning up the air in California, our initial approach was political and legislative. Through our

public policy work, we became familiar with a number of organizations that needed financial support to pursue a clean air agenda. And our grant to the Natural Resources Defense Council to maintain current environmental legislation resulted from our keen awareness of the potential consequences of new regulations and laws supported by the new Administration.

Our flexible grantmaking enables us to participate in major policy debates when we have identified a specific outcome to an issue as critical to our goals. When the issue of federal funding for embryonic stem cell research became a national topic, for example, we knew our medical grant resources would be best leveraged in the long term if federal funding of stem cell research became a reality. Our grant in support of the Coalition for the Advancement of Medical Research (CAMR) enabled us to have a voice and role in the debate that far exceeded the financial value of the grant. We became an active member of CAMR and made use of our political contacts to promote federal funding.

## Lobbying and Advocacy

One of our defining attributes is that we actively participate in the development of public policy to further our vision. Consistent with our desire to effect change at various levels, we led or contributed to several

significant policy debates during the year. The election of a new U.S. President heralded a mid-year shift in our lobbying focus from California clean air issues to the disturbing possibility of increased threats from the use of weapons of mass destruction, particularly nuclear arsenals. We also found ourselves drawn into the national discussion over federal funding of embryonic stem cell research because of its potential to cure diseases. Highlights of our activities and successes in lobbying and advocacy include:

### Environment

- Sponsoring zero-emission vehicle (ZEV) incentive legislation that provides a grant to bring the cost of leasing a ZEV close to price parity with gasoline vehicles (California Assembly Bill 2061, Alan Lowenthal, D-54th District), securing its passage by both houses of the State Legislature, and obtaining Governor Gray Davis's signature.
- Helping to defeat Proposition 37, which would have prohibited California from levying mitigation fees for environmental pollution without a two-thirds vote of the State Legislature, on the November 2000 ballot.
- Working as part of the statewide ZEV Alliance to ensure that the California Air Resources Board (CARB) held fast to its rule requiring automakers to produce and sell ZEVs in substantial numbers by 2003.

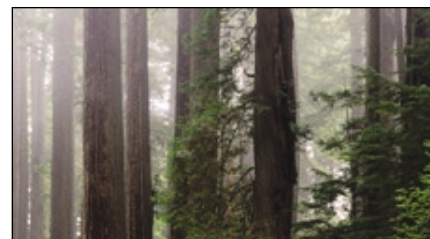

### Nuclear Disarmament

- Adopting a strong position in opposition to a National Missile Defense system, and in support of unilateral reduction of U.S. nuclear warheads, the lowering of alert status of U.S. and Russian nuclear missiles ("de-alerting"), and reconsideration and ratification of the Comprehensive Test Ban Treaty.
- Contacting elected officials and senior Administration officials to discuss, and request careful consideration of, an alternate nuclear posture.



### Lobbying and Advocacy - *Continued*

#### Medical/Science

- Supporting federal funding for embryonic stem cell research, given that stem cells hold great promise for curing devastating diseases such as Alzheimer's disease, cancer, heart disease, spinal cord injury and diabetes, by active participation in a coalition including patient groups, scientists and other funders of research.
- Urging Congressional members to pressure the Administration to approve federal funding of all stem cell research.

#### Campaign Finance Reform

- Advocating passage of clean money initiatives in Oregon and Missouri in the November 2000 vote by supporting Public Campaign Action Fund both financially and through extensive information on the Foundation's website.



*Kirsch Foundation Staff: (top row, left to right) Carla Pantoja, Public Policy and Communications Assistant; Connie Padre, Executive Assistant; May van Scherrenburg, Program Assistant, Medical and Scientific Programs; Sarah J. Caddick, PhD, Director, Medical and Scientific Programs. (Bottom row, left to right) Kathleen Gwynn, President/CEO/CFO; Susan E. Frank, Director, Public Policy.*

## Grants

### Overview

We made grant payments of \$4,594,830 through our program areas.

Environmental.....	17 grants.....	\$ 399,000
Kirsch Investigator Awards.....	8 grants.....	1,440,000
Medical/Science Projects.....	4 grants.....	360,000
Political Reform and Global Issues.....	6 grants.....	575,000
Silicon Valley Community.....	64 grants.....	1,169,580
Discretionary.....	24 grants.....	651,250

### Summary

As part of our continuing evolution as a new Foundation:

- We honed the focus of our Environmental Grants Program to complement and augment our advocacy of clean air.
- We identified and funded key initiatives in political reform (efforts to reform the U.S. election process in light of the 2000 Presidential election) and nuclear disarmament (an alternative nuclear posture review for the new Presidential Administration to consider).
- We designed and began to implement a creative model for funding medical science research that builds on our risk-taking approach and leverages our limited resources.
- We demonstrated our continued commitment to Silicon Valley, our local community, with substantial operating support and capital and program funding.

We were pleased that the Glaucoma Research Foundation, a leading funder of research in the area, agreed with our ideas and became our partner in this new, creative research approach.

### Kirsch Center for Environmental Studies – DeAnza College

To further our environmental goals, to establish a model project, and to support our local community and its residents, we made a \$2 million grant to De Anza College to initiate its campaign to construct the first-ever "green building" on a community college campus. This landmark Center will also be the first of its kind on any college campus west of the Mississippi.

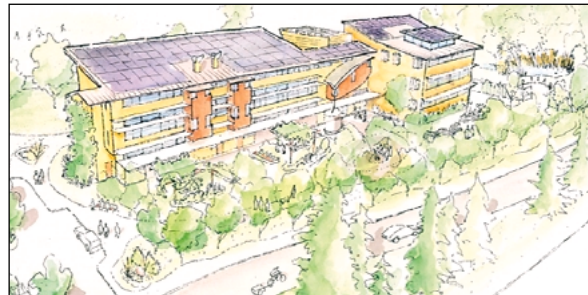

*Artist's rendering of the planned, environmentally-friendly Kirsch Center.*

### Major Grants

Four grants are representative of significant Foundation initiatives during the year:

#### Catalyst for a Cure

In a joint venture with the Glaucoma Research Foundation, we launched a new model for medical research project funding: collaborative funding for collaborative research teams. After months of discussion and research, the Foundation's Board adopted this new model in order to meet two key objectives: leverage of our financial resources and a keen focus on determining and then meeting measurable outcomes. We believed that research into glaucoma, a debilitating eye disease, would benefit from bringing new researchers into the field.

Some of the environmentally-friendly design specifics the Kirsch Center will incorporate are: passive solar orientation and photovoltaic (PV) panels for energy production, natural day-lighting and ventilation, recycled steel, certified sustainable wood products, electric vehicle recharging stations and a pollution prevention and waste management plan. Equally important, we know that other educational and governmental leaders will become educated on the use of renewable and energy-efficient technologies in buildings, thus leveraging our grant.

## Grants - Continued

### Mills College – Kirsch Building at Education Complex

As a graduate of Mills College and a strong proponent of quality education, Michèle Kirsch made a \$1 million contribution to the College to advance its highly regarded teacher preparation program.



*Mills College President Janet L. Holmgren (on left) with Michèle Kirsch at the ribbon-cutting ceremony for the Kirsch Building.*

Each year, 150 graduate students work toward a teaching credential, Master's degree or Doctoral degree in education. The new, three-building Education Complex opened in April of 2000. The Kirsch Building, already in use, houses the classrooms and faculty offices of the Education Department.

### ACLU Foundation of Florida – The Florida Project on Equal Voting Rights

Given our democracy is based on "one person, one vote" and our political system requires reform to ensure that elected and appointed officials are accountable to the people, we made a \$300,000 grant to the ACLU. Its purpose was to seek changes in the Florida voting system to guarantee that the right to vote and the right to have one's vote accurately recorded and counted are respected.

Following the November 2000 election, the Florida ACLU received numerous complaints that there were efforts to intimidate voters, that voters were not allowed to vote if they did not produce two picture identifications and that the names of registered voters were missing from the official voter rolls. The ACLU has been working with the state legislature and through the courts to reduce racial and other disparities that were evident and to establish standards for recounting disputed ballots and procedures for processing absentee ballots. With the nation's attention focused on Florida in the aftermath of the 2000 election, we expect that the successes of the Florida ACLU will lead to similar changes in other parts of the U.S., thus leveraging our resources.



*Kirsch Foundation Board and Officers: (top row, left to right) Peter deCourcy Hero, Secretary; Kathleen Gwynn, President/CEO/CFO; Harry J. Saal, Vice-Chairman. (Bottom row, left to right) Perry Olson, Vice-Chairman; Steven T. Kirsch, Chairman.*



This list, totaling \$4,825,830, displays all grants approved by the Board, including total commitments for multi-year grants, with the exception of pass-through grants made by the Foundation doing business as the Internet Giving Foundation. Learn more about these organizations by visiting each organization's website.

## Environmental

American Lung Association <a href="http://www.californialung.org">http://www.californialung.org</a>	\$50,000
Breakthrough Technologies Institute <a href="http://www.yournextcar.org">http://www.yournextcar.org</a>	25,000
CalPIRG Charitable Trust <a href="http://www.calpirg.org">http://www.calpirg.org</a>	25,000
Chemical Strategies Partnership <a href="http://www.chemicalstrategies.org">http://www.chemicalstrategies.org</a>	22,000
Coalition for Clean Air <a href="http://www.coalitionforcleanair.org">http://www.coalitionforcleanair.org</a>	25,000
Earth Communications Office <a href="http://www.oneearth.org">http://www.oneearth.org</a>	17,000
Environmental Working Group <a href="http://www.ewg.org">http://www.ewg.org</a>	25,000
Friends of the Earth <a href="http://www.foe.org">http://www.foe.org</a>	25,000
Izaak Walton League of America <a href="http://www.iwla.org">http://www.iwla.org</a>	25,000
Los Angeles County Bicycle Coalition <a href="http://www.labikecoalition.org">http://www.labikecoalition.org</a>	25,000
Natural Resources Defense Council <a href="http://www.nrdc.org">http://www.nrdc.org</a>	25,000
Project Clean Air <a href="http://www.projectcleanair.org">http://www.projectcleanair.org</a>	25,000
Taxpayers Against Polluter Protection <a href="http://www.nextgeneration.org/noon37/">http://www.nextgeneration.org/noon37/</a>	20,000
Union of Concerned Scientists <a href="http://www.ucsusa.org">http://www.ucsusa.org</a>	15,000
University of California, Davis <a href="http://www.engr.ucdavis.edu/~its/">http://www.engr.ucdavis.edu/~its/</a>	25,000
University of Delaware <a href="http://www.udel.edu">http://www.udel.edu</a>	25,000

## Kirsch Investigator Awards

Dr. Allison Doupe, MD, PhD, University of California, San Francisco	\$180,000
Dr. Geraldine Seydoux, PhD, Johns Hopkins School of Medicine	180,000
Dr. Jonathan Tilly, PhD, Massachusetts General Hospital	180,000
Dr. Susan Wenthe, PhD, Washington University	180,000

## Medical/Science Projects

Academy for International Health Philanthropy <a href="http://www.healthphilanthropy.org">http://www.healthphilanthropy.org</a>	\$ 25,000
Glaucoma Research Foundation <a href="http://www.kirschfoundation.org/who/affiliated.html#Anchor-Glaucom-37279">http://www.kirschfoundation.org/who/affiliated.html#Anchor-Glaucom-37279</a>	575,000
The American Society for Cell Biology <a href="http://www.ascb.org">http://www.ascb.org</a>	30,000
University of Arizona <a href="http://www.lpl.arizona.edu/spacewatch/">http://www.lpl.arizona.edu/spacewatch/</a>	100,000

## Political Reform and Global Issues

Californians Against Phony Reform-NO on 34 <a href="http://www.voteno34.org">http://www.voteno34.org</a>	\$ 50,000
Global Security Institute <a href="http://www.gs-institute.org">http://www.gs-institute.org</a>	25,000
Ploughshares Fund <a href="http://www.ploughshares.org">http://www.ploughshares.org</a>	100,000
Public Campaign Action Fund <a href="http://www.publiccampaign.org">http://www.publiccampaign.org</a>	100,000
Union of Concerned Scientists <a href="http://www.ucsusa.org">http://www.ucsusa.org</a>	50,000

## Silicon Valley Community

American Musical Theater of San Jose <a href="http://www.amtsj.org">http://www.amtsj.org</a>	\$ 90
American Red Cross, Palo Alto Area Chapter <a href="http://www.paarc.org">http://www.paarc.org</a>	20,000
Arts Council Silicon Valley <a href="http://www.artscouncil.org">http://www.artscouncil.org</a>	470
Brave Kids <a href="http://www.bravekids.org">http://www.bravekids.org</a>	5,000
Bullis-Purissima School PTA <a href="http://bullis.losaltos.k12.ca.us/">http://bullis.losaltos.k12.ca.us/</a>	10,000
Campfire Boys and Girls <a href="http://www.campfire-sc.org">http://www.campfire-sc.org</a>	20,000
Children's Discovery Museum <a href="http://www.cdm.org">http://www.cdm.org</a>	5,000
Clara-Mateo Alliance <a href="http://www.clara-mateo.org">http://www.clara-mateo.org</a>	15,000
Coalition for Excellence in Science Education <a href="http://www.hpretirees.com/hprv/current-projects.htm">http://www.hpretirees.com/hprv/current-projects.htm</a>	5,000
Community Foundation Silicon Valley <a href="http://www.cfsv.org">http://www.cfsv.org</a>	137,500
Community School of Music and Arts <a href="http://www.arts4all.org/">http://www.arts4all.org/</a>	15,000
Computer Museum History Center <a href="http://www.computerhistory.org">http://www.computerhistory.org</a>	25,000

East Palo Alto Kids Foundation <a href="http://www.epak.org">http://www.epak.org</a>	20,000
East San Jose Community Resource Center <a href="http://www.svdvp.org">http://www.svdvp.org</a>	100,000
Environmental Volunteers <a href="http://www.evols.org">http://www.evols.org</a>	25,000
Facing History and Ourselves <a href="http://www.facing.org">http://www.facing.org</a>	25,000
Family Service Mid-Peninsula <a href="http://www.fcservices.org">http://www.fcservices.org</a>	10,000
Ground Zero <a href="http://www.groundzero.org">http://www.groundzero.org</a>	10,000
Homeless Care Force <a href="http://www.smprsv.com/ministries/">http://www.smprsv.com/ministries/</a>	25,000
Hospice of the Valley <a href="http://www.hospicevalley.org">http://www.hospicevalley.org</a>	35,000
Housing Trust Fund <a href="http://www.housingtrustfund.org">http://www.housingtrustfund.org</a>	1,000
Humane Society of Santa Clara Valley <a href="http://www.scvhumane.org">http://www.scvhumane.org</a>	3,300
Industry Initiatives for Science and Math Education <a href="http://iisme.org">http://iisme.org</a>	26,750
International Law Society <a href="http://www-acc.scu.edu/Clubs/ilsa/homepage.html">http://www-acc.scu.edu/Clubs/ilsa/homepage.html</a>	10,000
Junior Achievement of Santa Clara County, Inc. <a href="http://www.jascc.org">http://www.jascc.org</a>	1,500
Junior League of Palo Alto-Mid Peninsula <a href="http://www.thejuniorleague.org">http://www.thejuniorleague.org</a>	30,150
Law Foundation of Silicon Valley <a href="http://www.lawfoundation.org">http://www.lawfoundation.org</a>	14,100
Learning and Loving Education Center <a href="http://home.pacbell.net/edctr/">http://home.pacbell.net/edctr/</a>	10,000
Los Altos Cultural Association	5,000
Los Altos Educational Foundation <a href="http://www.springer.losaltos.k12.ca.us/thank_you/laef">http://www.springer.losaltos.k12.ca.us/thank_you/laef</a>	10,000
Los Altos Town Crier Holiday Fund <a href="http://www.losaltosonline.com/latc.html">http://www.losaltosonline.com/latc.html</a>	5,000
Menlo School <a href="http://www.menloschool.org">http://www.menloschool.org</a>	25,000
Next Door <a href="http://www.nextdoor.org">http://www.nextdoor.org</a>	3,800
Palo Alto Art Center Foundation <a href="http://www.city.palo-alto.ca.us/artcenter">http://www.city.palo-alto.ca.us/artcenter</a>	5,000
Palo Alto Medical Foundation <a href="http://www.pamf.org">http://www.pamf.org</a>	2,500
Parent Observation	5,000
Parents Helping Parents <a href="http://www.php.com">http://www.php.com</a>	10,000
Peninsula Center for the Blind and Visually Impaired <a href="http://www.pcbvi.org/ui/index.htm">http://www.pcbvi.org/ui/index.htm</a>	3,070
Planned Parenthood Mar Monte <a href="http://www.plannedparenthood.org">http://www.plannedparenthood.org</a>	50,000
Rebuilding Together <a href="http://www.rebuildingtogetherpeninsula.org">http://www.rebuildingtogetherpeninsula.org</a>	10,000
San Jose Mercury News Wish Book Fund <a href="http://www0.mercurycenter.com/special/wishbook/">http://www0.mercurycenter.com/special/wishbook/</a>	10,000
San Jose Symphony <a href="http://www.sanjosesymphony.org">http://www.sanjosesymphony.org</a>	100
Santa Clara University School of Law <a href="http://www.scu.edu/SCU/Departments/Law">http://www.scu.edu/SCU/Departments/Law</a>	2,500
Shelter Against Violent Environments <a href="http://www.save-dv.org">http://www.save-dv.org</a>	10,000
Shelter Network <a href="http://www.shelternetwork.org">http://www.shelternetwork.org</a>	25,000
Stanford Sleep Disorders Clinic <a href="http://www.med.stanford.edu/school/psychiatry/sleepclinic/">http://www.med.stanford.edu/school/psychiatry/sleepclinic/</a>	1,000
The Health Trust <a href="http://www.healthtrust.org">http://www.healthtrust.org</a>	35,000
The Tech Museum of Innovation <a href="http://www.thetech.org">http://www.thetech.org</a>	269,250
Unity Care Group <a href="http://www.unitycare.com">http://www.unitycare.com</a>	12,500

## Discretionary

American Civil Liberties Union (ACLU) Foundation of Florida <a href="http://www.aclufl.org">http://www.aclufl.org</a>	\$ 300,000
America's Promise <a href="http://www.americaspromise.org">http://www.americaspromise.org</a>	50,000
Athena Foundation <a href="http://www.athenafoundation.org">http://www.athenafoundation.org</a>	10,000
California State Parks Foundation <a href="http://www.calparks.org">http://www.calparks.org</a>	1,000
CARE <a href="http://www.care.org">http://www.care.org</a>	2,500
FIRST <a href="http://www.usfirst.org">http://www.usfirst.org</a>	25,000
Future Families, Inc. <a href="http://www.futurefamilies.org">http://www.futurefamilies.org</a>	2,500
Global Security Institute <a href="http://www.gsainstitute.org">http://www.gsainstitute.org</a>	5,000
Habitat for Humanity International <a href="http://www.habitat.org">http://www.habitat.org</a>	2,000
Milagro Foundation <a href="http://www.milagrofoundation.org">http://www.milagrofoundation.org</a>	500
Mills College <a href="http://www.mills.edu">http://www.mills.edu</a>	1,035,000
NetDay <a href="http://www.netday.org">http://www.netday.org</a>	10,000
Opportunities Industrialization Center West <a href="http://www.oicw.org">http://www.oicw.org</a>	1,000
Passport 2000 HIV/AIDS Benefit <a href="http://promotions.yahoo.com/promotions/macyspassport/">http://promotions.yahoo.com/promotions/macyspassport/</a>	15,250
San Francisco AIDS Foundation <a href="http://www.sfaf.org">http://www.sfaf.org</a>	15,000
San Francisco Boys and Girls Clubs <a href="http://www.sfbgc.org">http://www.sfbgc.org</a>	16,000
San Francisco Zoological Society <a href="http://www.sfbzoo.org">http://www.sfbzoo.org</a>	1,000
Snowline Hospice <a href="http://www.snowlinehospice.org">http://www.snowlinehospice.org</a>	500
Steadman-Hawkins Sports Medicine Foundation <a href="http://www.shsmf.org">http://www.shsmf.org</a>	25,000
World Affairs Council of Northern California <a href="http://www.wacsf.org">http://www.wacsf.org</a>	5,000
World Institute on Disability <a href="http://www.wid.org">http://www.wid.org</a>	25,000

## Financial Statements

### Balance Sheet

(As of June 30, 2001)

#### Assets

Cash and equivalents	\$ 17,606
Investments, at fair value (See Note 1)	36,169,544

<b>Total Assets</b>	<b>\$ 36,187,150</b>
---------------------	----------------------

#### Liabilities and Net Assets

Liabilities	
Grants Payable	\$ 3,749,334
Accrued Expenses & Other Liabilities	29,728
<b>Total Liabilities</b>	<b>3,779,062</b>

Total Net Assets	32,408,088
------------------	------------

<b>Total Liabilities and Net Assets</b>	<b>\$ 36,187,150</b>
---	----------------------

### Statement of Activities

(For the year ended June 30, 2001)

#### Revenue

Contributions - Internet Giving Foundation	\$ 465,506
Interest and Dividend Income	142,960
Net Realized Gain (Loss) on Investments	(19,403,977)
Net Unrealized Gain (Loss) on Investments	(16,477,493)
<b>Total Revenue</b>	<b>(35,273,004)</b>

#### Expenses

Grants Authorized (See Note 2)	4,825,830
Grants Authorized - Internet Giving Foundation	465,506
CFSV Support Fee (See Note 3)	430,243
Administration	711,271
<b>Total Expenses</b>	<b>6,432,849</b>

<b>Change in Net Assets</b>	<b>(41,705,854)</b>
-----------------------------	---------------------

<b>Beginning Net Assets</b>	<b>74,113,941</b>
-----------------------------	-------------------

<b>Ending Net Assets, June 30, 2001</b>	<b>\$ 32,408,088</b>
---	----------------------

Note 1: This includes \$628,755 in venture capital funds and an investment in LearnNow, Inc.

Note 2: This includes multi-year grants awarded but not yet fully disbursed.

Note 3: Fee to Community Foundation Silicon Valley as a supporting organization.

# kirschfoundation

**Steven and Michèle Kirsch Foundation**

60 South Market Street, Suite 1000  
San Jose, CA 95113 - 2336

(408) 278-2278

(408) 278-0280 (fax)

[www.kirschfoundation.org](http://www.kirschfoundation.org)

**Credits:**

Design: [tristream.com](http://tristream.com)

Editors: Kathleen Gwynn and Connie Padre

Photography: Mary Merrick

Additional images courtesy of:

American Musical Theater of San Jose

American Red Cross, Palo Alto Area Chapter

Elizabeth H. Blackburn, PhD

De Anza College

Mills College